

# Archer 1200 Barrier

The world's most crash-tested mobile vehicle barrier



## Simple deployment

- ✓ Modular barrier
- ✓ Expandable footprint
- ✓ Compatible with all Meridian products

## Built to last

- ✓ Over 20 certified configurations
- ✓ Leader in crash test certifications
- ✓ Reusable after impact

## Proven performance

- ✓ No hydraulics
- ✓ No electricity
- ✓ No forklifts
- ✓ One person deployment
- ✓ Maintenance free
- ✓ Lifetime warranty

## Modular configurations

From single barriers to complete perimeter systems. Configure for any security requirement.



Scan to see it in action

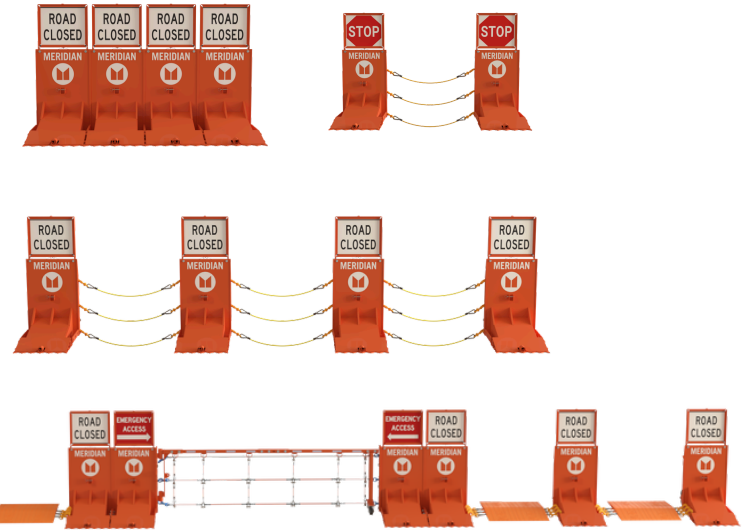

Buy or Rent

(434) 529-6903

[www.meridian-barrier.com](http://www.meridian-barrier.com)

